

15.Rear Gate Glass

A: REMOVAL

- 1) Remove the rear gate garnish. <Ref. to EB-20, REMOVAL, Rear Gate Garnish Assembly.>
- 2) Remove the electrical connector from rear de-fogger terminal.
- 3) Remove the glass in same procedure as for windshield glass. <Ref. to GW-24, REMOVAL, Windshield Glass.>

NOTE:

A matching pin is cemented to corners of the glass on the compartment side. Use a piano wire when cutting each pin.

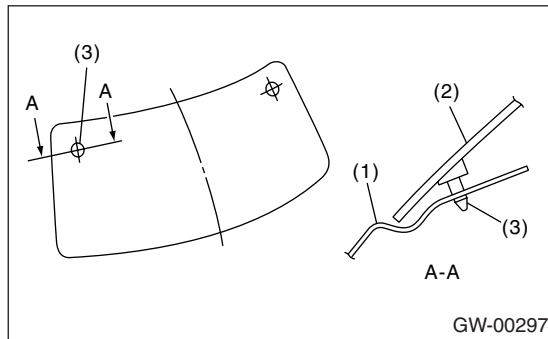

- (1) Body panel
- (2) Glass
- (3) Matching pin

B: INSTALLATION

- 1) Install a new rubber strip (A) by aligning it with the end of the rear gate glass (B).

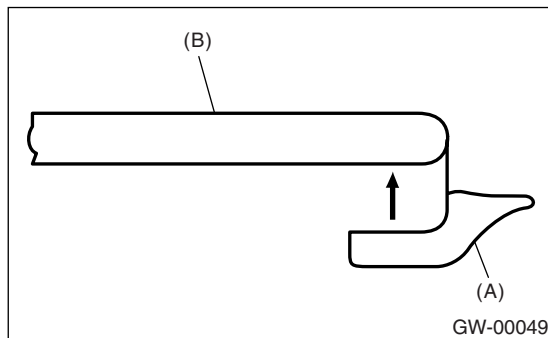

- 2) Install the glass in same procedure as for windshield glass.

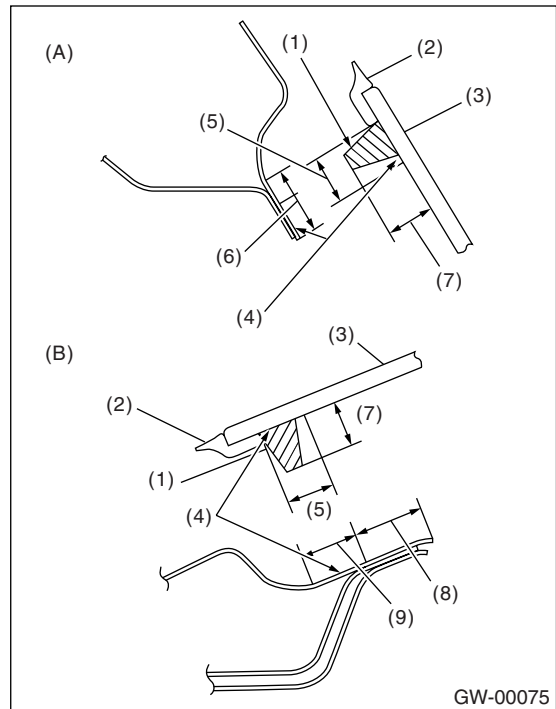

- A) Upper side
- B) Left and right side
- (1) Adhesive
- (2) Strip rubber
- (3) Glass
- (4) Primer
- (5) 12 mm (0.47 in)
- (6) 14 mm (0.55 in)
- (7) 10 — 13 mm (0.39 — 0.51 in)
- (8) 8 mm (0.31 in)
- (9) 12 mm (0.47 in)

REAR GATE GLASS

GLASS/WINDOWS/MIRRORS

3) About one hour after installation, conduct a leak test.

4) After completion of all work, allow the vehicle to stand for about 24 hours.

NOTE:

- When the door is opened/closed after glass is bonded, always lower the door glass and then open/close it carefully.
- Move the vehicle slowly.
- For minimum drying time and time the vehicle must be left standing before driving after bonding, follow instructions or instruction manual from the adhesive manufacturer.
- When a vehicle is returned to the user, tell him or her that the vehicle should not be subjected to heavy impact for at least three days.

5) Connect the rear defogger terminals.

6) Install the rear gate garnish. <Ref. to EB-20, INSTALLATION, Rear Gate Garnish Assembly.>