

# SWITCHES AND HARNESS

## MANUAL TRANSMISSION AND DIFFERENTIAL

### 7. Switches and Harness

#### A: REMOVAL

##### 1. BACK-UP LIGHT AND NEUTRAL POSITION SWITCH

- 1) Disconnect the ground cable from battery.
- 2) Remove the air intake duct and cleaner case. <Ref. to IN(H4SO)-6, REMOVAL, Air Cleaner Case.>
- 3) Remove the intercooler (Turbo model). <Ref. to IN(H4DOTC)-10, REMOVAL, Intercooler.>
- 4) Disconnect the connector of back-up light switch and neutral position switch.

##### • NON-TURBO MODEL

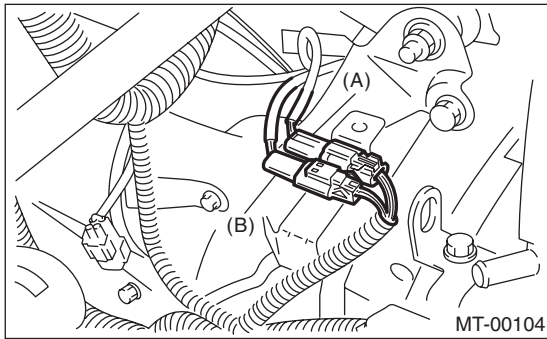

- (A) Neutral switch (Brown)
- (B) Back-up light switch (Gray)

##### • TURBO MODEL

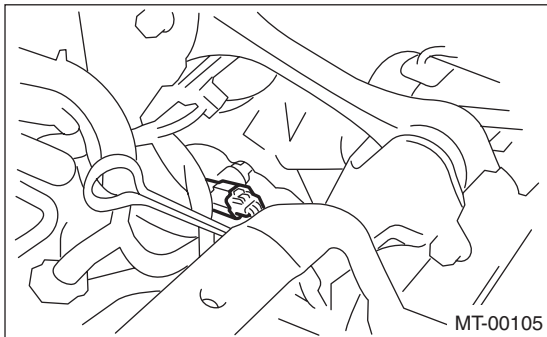

- 5) Lift-up the vehicle.

- 6) Remove the back-up light switch and neutral position switch with harness.

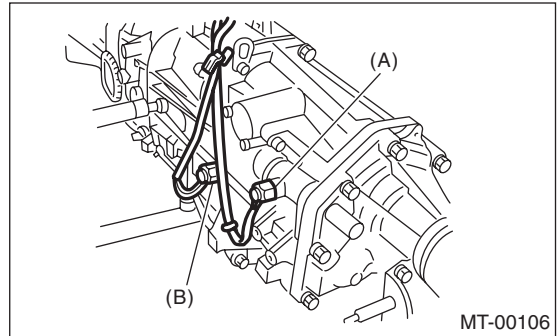

- (A) Neutral switch (Brown connector)
- (B) Back-up light switch (Gray connector)

#### B: INSTALLATION

##### 1. BACK-UP LIGHT SWITCH AND NEUTRAL POSITION SWITCH

- 1) Install the back-up light switch and neutral position switch with harness.

##### **Tightening torque:**

**24.5 N·m (2.5 kgf-m, 18.1 ft-lb)**

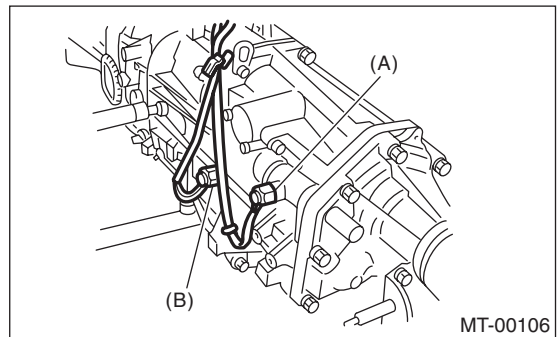

- (A) Neutral switch
- (B) Back-up light switch

- 2) Connect the connector of back-up light switch and neutral position switch.
- 3) Install the air intake duct and cleaner case. <Ref. to IN(H4SO)-6, INSTALLATION, Air Cleaner Case.>
- 4) Install the intercooler. (Turbo model) <Ref. to IN(H4DOTC)-11, INSTALLATION, Intercooler.>
- 5) Connect the battery ground cable to battery.

## C: INSPECTION

### 1. BACK-UP LIGHT SWITCH

Inspect the back-up light switch. <Ref. to LI-6, INSPECTION, Back-up Light System.>

### 2. NEUTRAL POSITION SWITCH

- 1) Turn the ignition switch to OFF.
- 2) Disconnect the connector of neutral position switch.
- 3) Measure the resistance between neutral position switch terminals.

#### Non-turbo model:

Gear shift position	Terminal No.	Specified resistance
Neutral position	1 and 2	Less than 1 $\Omega$
Other positions		More than 1 M $\Omega$

#### Turbo model:

Gear shift position	Terminal No.	Specified resistance
Neutral position	1 and 3	Less than 1 $\Omega$
Other positions		More than 1 M $\Omega$

- NON-TURBO MODEL

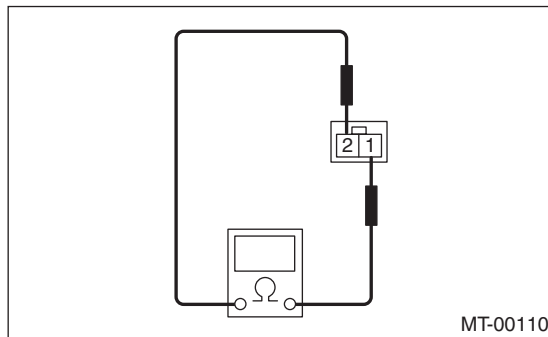

- TURBO MODEL

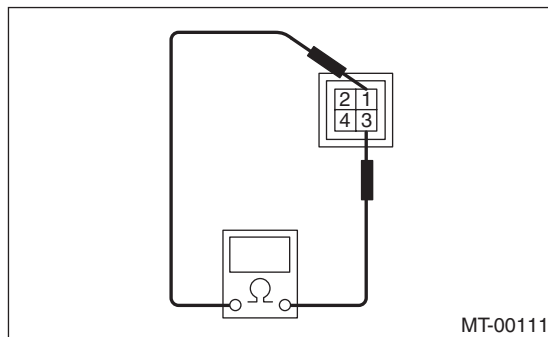

- 4) Replace defective parts.